



BUILDING HAPPINESS.,!

NEXA'S VS BARATHI ENCLAVE

98401 44022 | 87544 15020

Plot No. 263, 11th Street, TNHB Colony, Korattur, Chennai - 80.

STILT FLOOR

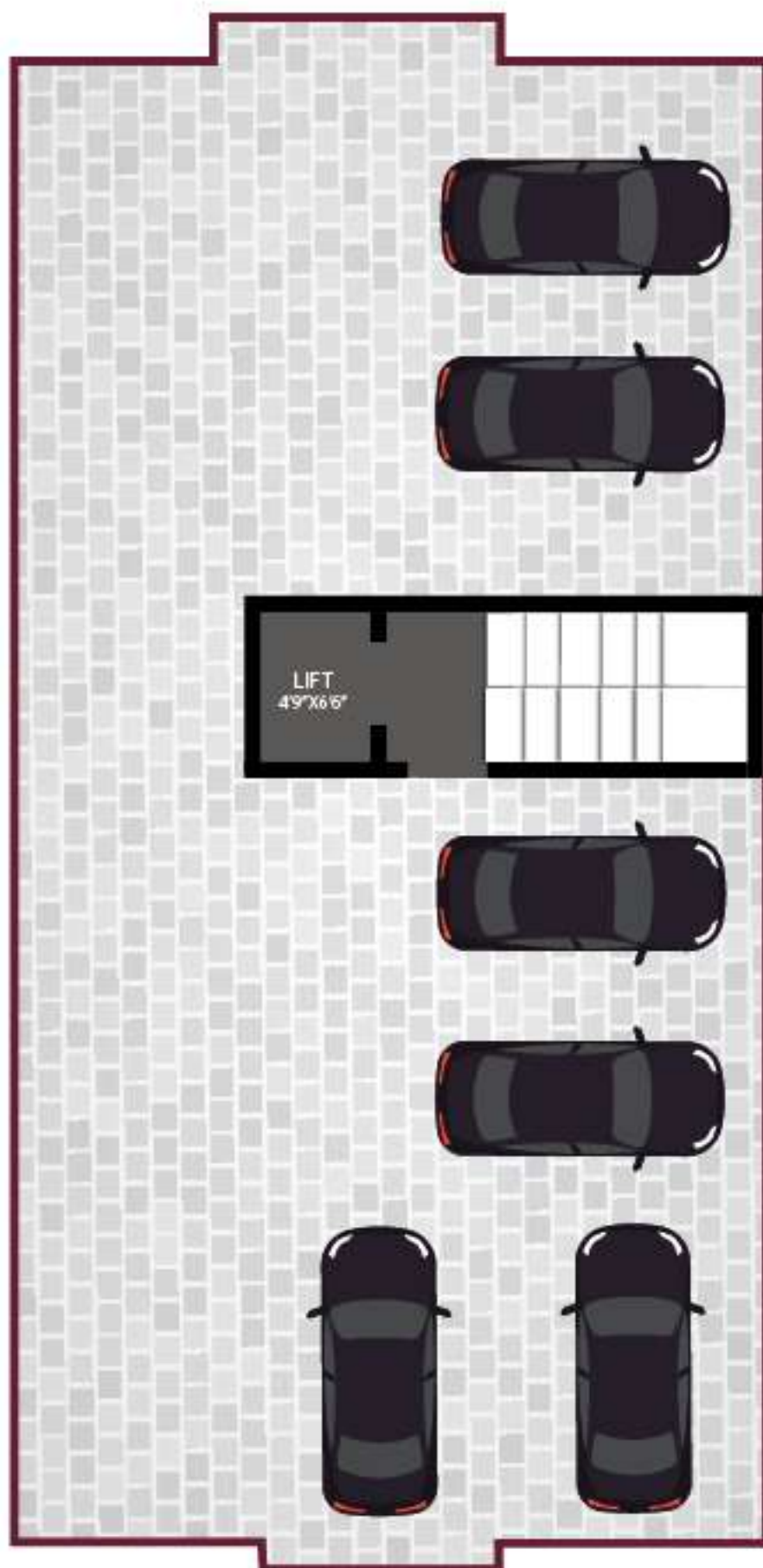

1st, 2nd, 3rd FLOOR



ONGOING PROJECTS



Hive
Plot No: 3 - ABC, Jeevanrath Nagar
5th Mainroad A.N.A. Annamalai Ave, Ch - 37.
Flats starting from 1700-1930 sq.ft



GS Enclave
No: 23, 62nd Street,
Ashok Nagar, Ch - 63.
Flats starting from 1085 - 1265 sq.ft



Apsara
No. 208 periyar Nagar 9th street THHB,
Korattur, Ch - 60.
Flats starting from 735 - 1310 sq.ft



Baba Nagar
Plot no: 352, 15th street Babanagar,
Mylaboliom, Ch - 48.
Flats starting from 901 - 1002 sq.ft



Sunshine
Plot No 31, 2nd street, Cauvery Nagar,
Saidapet, Ch - 15.
Flats starting from 865 - 950 sq.ft



Atria
No.158-A 6th Street, TNHUB Colony,
Korattur, Ch - 60.
Flats starting from 900 - 1100 sq.ft

PROJECT SPECIFICATION:

FOUNDATION & STRUCTURE

- ❖ RCC column, beam, and slab frame structure, Stilt + 4 floors.
- ❖ 9' thick outer walls & 4.5" thick internal walls with Wirecut Red Brick masonry filler and cement plastering.

FLOOR FINISHES

- ❖ Living, dining, and kitchen with SOMANY/KAJARIA vitrified flooring (2x2).
- ❖ Balconies, utilitarian vitrified tiles with a matte finish, and non-skid tiles.
- ❖ Bathroom - The ceiling will be coated with two coat of emulsion and premium glazed ceramic tiles up to a ceiling height of 300 x 450 mm and Anti-Skid tiles for the floor.

WALL COMPONENTS & PAINTING

- ❖ Outdoor Ace emulsion paints from Asian Paints.
- ❖ Internal Walls - Two coatings of putty were applied to the walls One coat of primer and Two coats of emulsion.

BATHROOM

- ❖ White glazed vitreous from Parryware makes EWC/IWC washbasin C.P fitting and other suitable fixtures from metro / Parryware / Carry on fittings.
- ❖ Health Faucet shall be provided in all toilets.
- ❖ Provision for exhaust fan & geyser.

DOORS & WINDOWS

- ❖ Main Entrance Door - Teak wood frame with an OST 40mm thick flush door that is 7'0" in height and has a Godrej lock or an equivalent company, tower bolt, a door viewer, and a door stopper.
- ❖ Bedroom Door - Solid wood frame with a flush door of 35 mm thickness, 7'0" in height, and locks made by Godrej or an equivalent company, as well as a thumb turn and a key.
- ❖ Bathroom doors - Solid wood frame, moulded skin, and a thumb turn lock made by Godrej or a comparable company.
- ❖ Windows - French UPVC openable windows and MS grills.

POWER & ELECTRICAL

- ❖ A three-phase electrical supply connection with a switchover facility, copper wiring with the ISI brand on it, and high-quality modular switches for power and lighting.
- ❖ As specified, provide the necessary lighting, fans, and plug points will be provided for all living spaces as per the client's requirements.